



醉花林品潮軒  
CHUI HUAY LIM TEOCHEW CUISINE

---

# CHUI HUAY LIM VENUE DECK

# Space Capacity



VENUE	AREA (SQM)	HEIGHT (M)	CAPACITY*
Hall A	510.09	6	340
Hall B	257.96	6	140
Hall A & B	768.05	6	520
Hall C	338.10	6	200
Hall C & J	-	6	300
Hall J	-	6	90

\*Subject to event configuration

# Configurations

## BANQUET

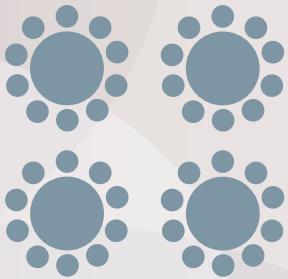

*\*Up to 11 pax per table*

## THEATRE

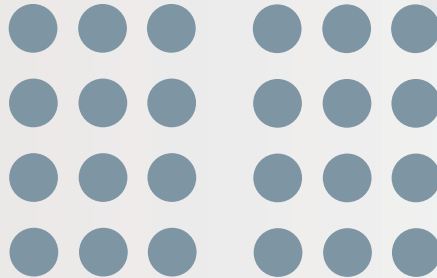

## U-SHAPE

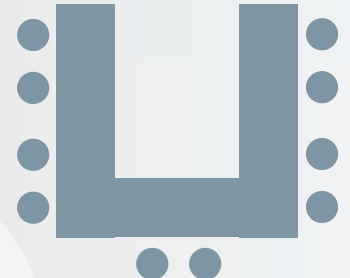

## BOARD ROOM

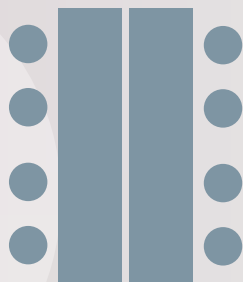

## CLASS ROOM

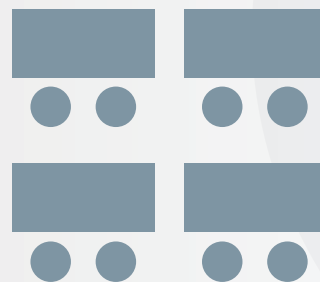

VENUE	BANQUET WEDDING	BANQUET CORPORATE	THEATRE	U-SHAPE	BOARD ROOM	CLASS ROOM
Hall A	210	230	442	-	-	80
Hall B	80	80	120	30	-	64
Hall A & B	300	320	-	-	-	120
Hall C	100	150	272	-	-	60
Hall C & J	160	210	416	-	-	80
Hall J	80	80	60	14	16	30

# Amber & Beryl

## HALL A & B

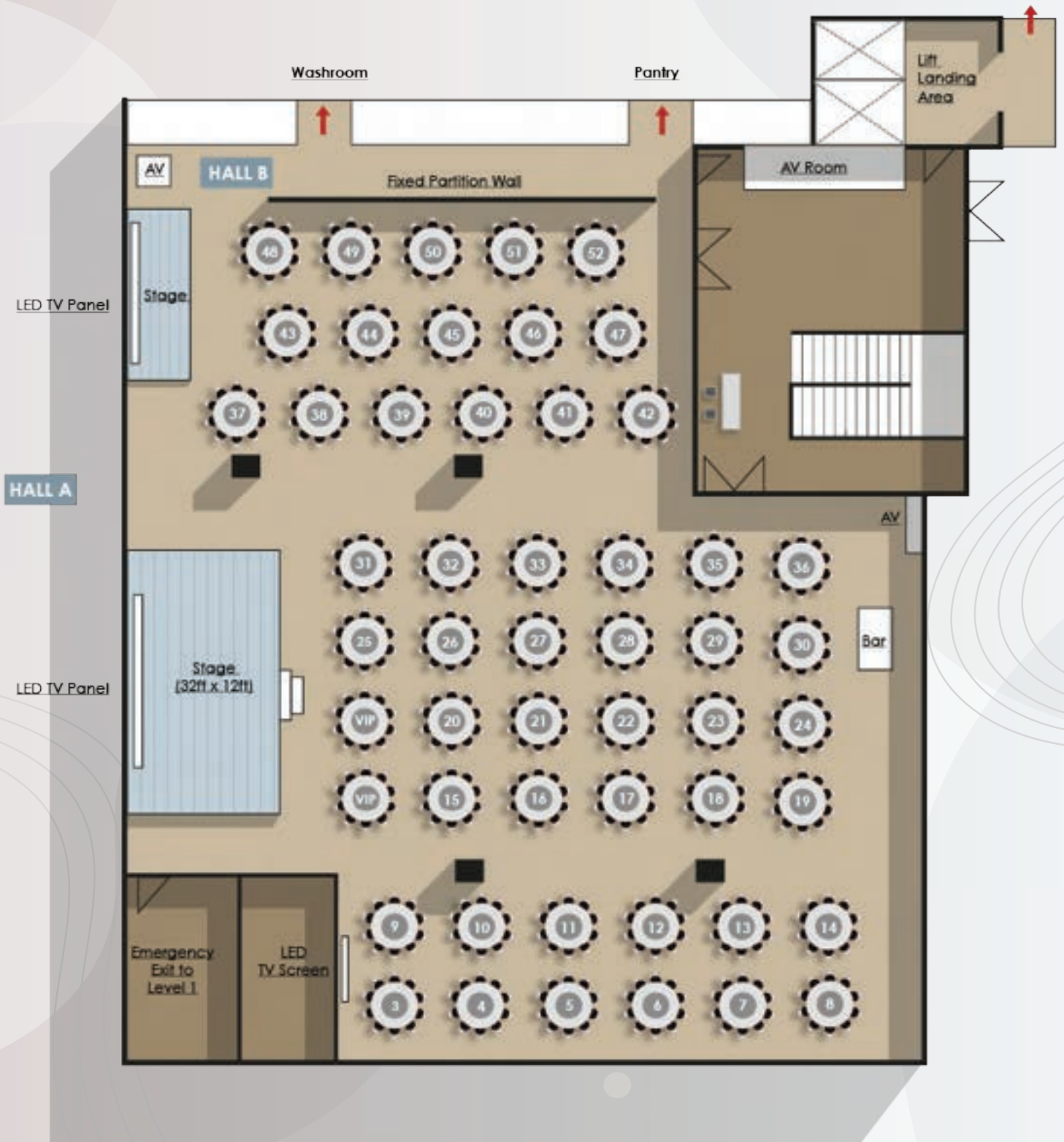

HALL A & B



# Celestine & Jade

## HALL C & J

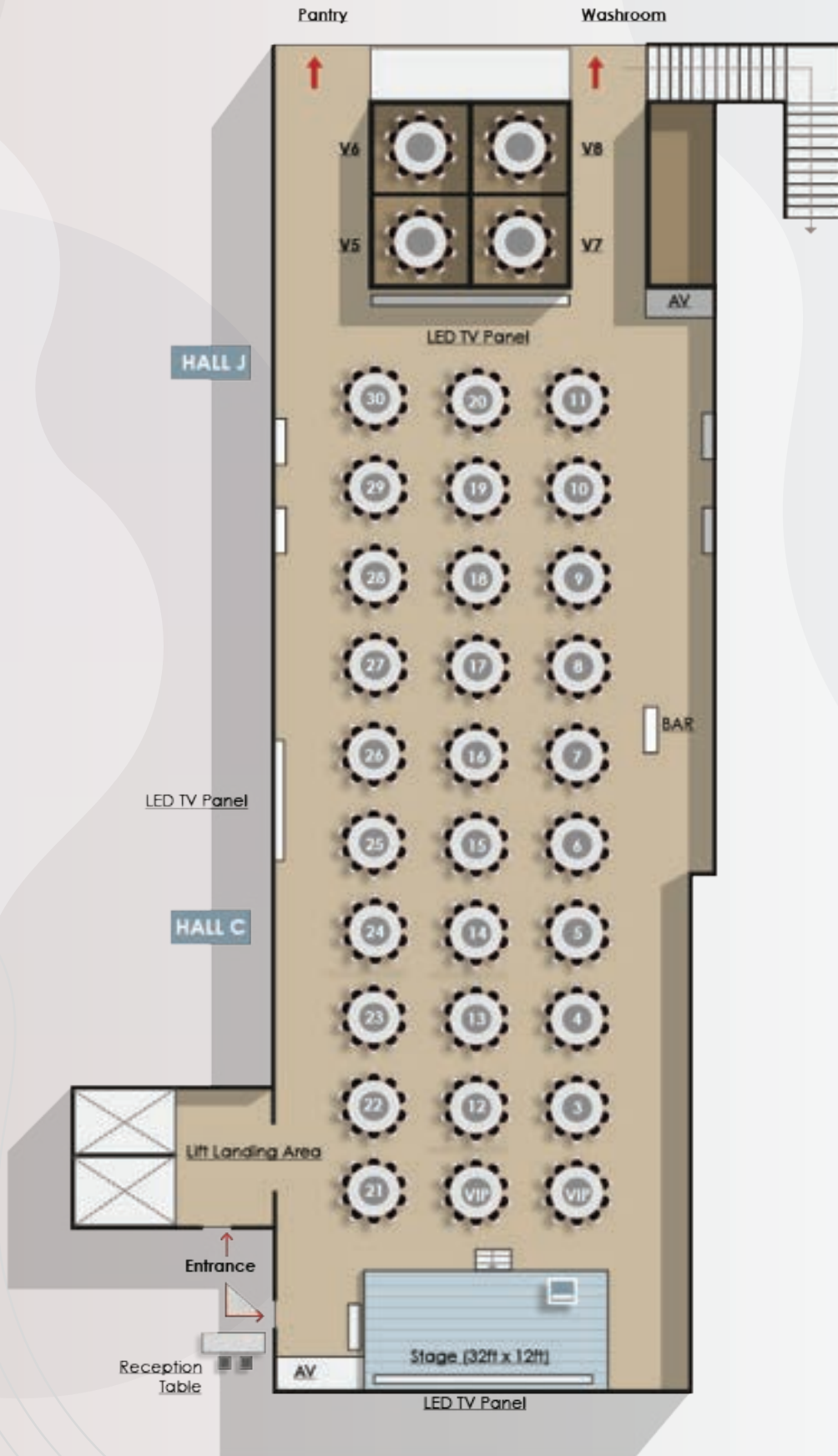

# Amber

## HALL A

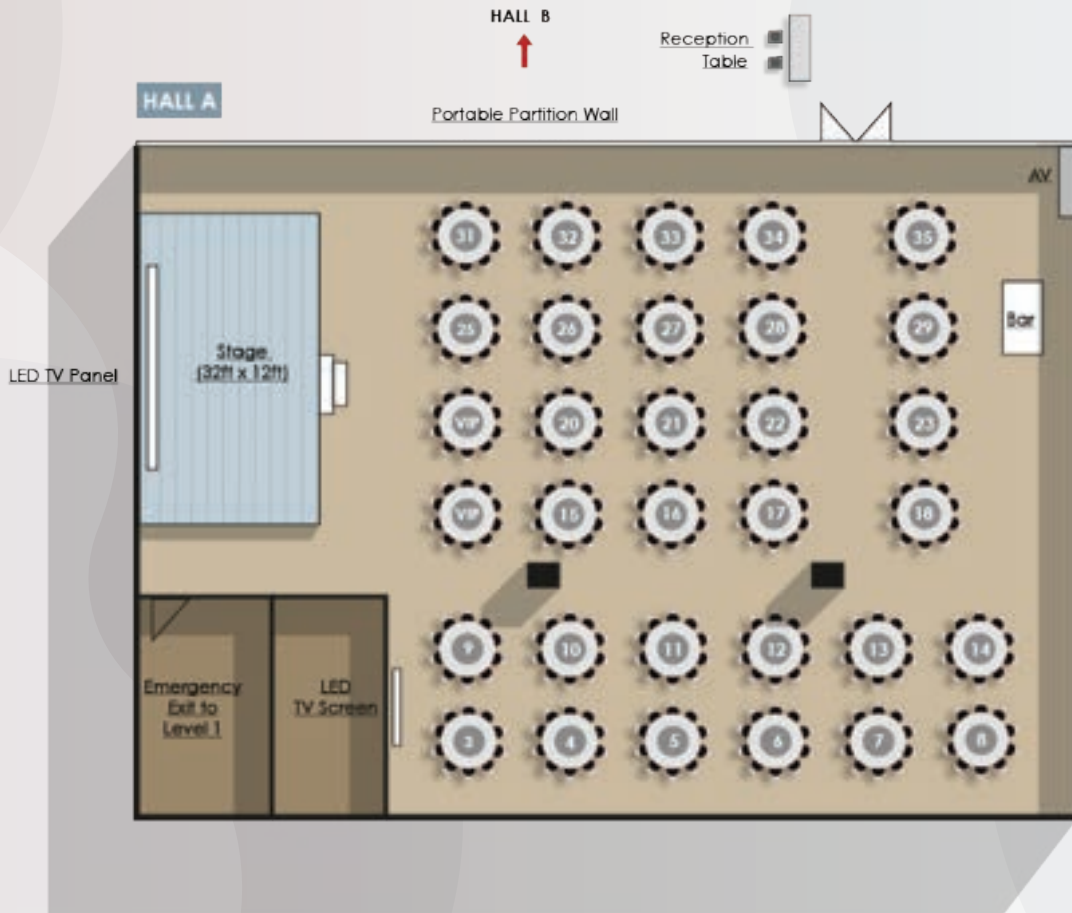

# Beryl

## HALL B

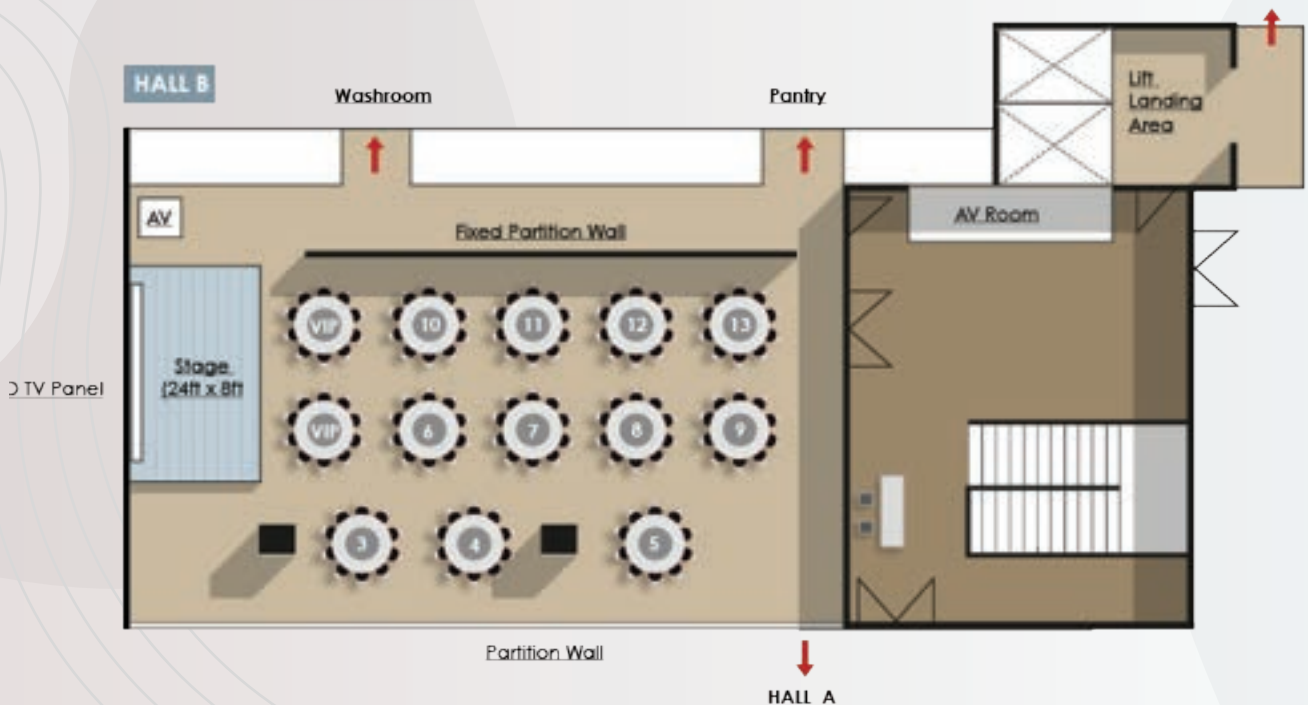

HALL A



HALL B



# Celestial

## HALL C

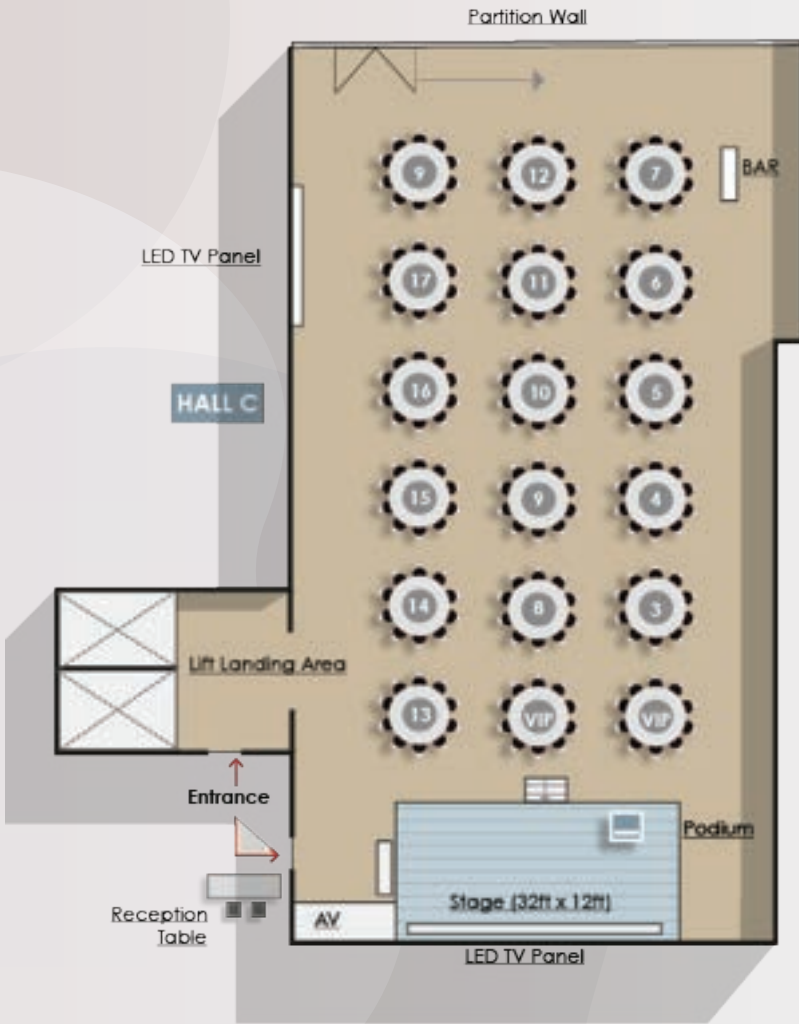

# Jade

## HALL J

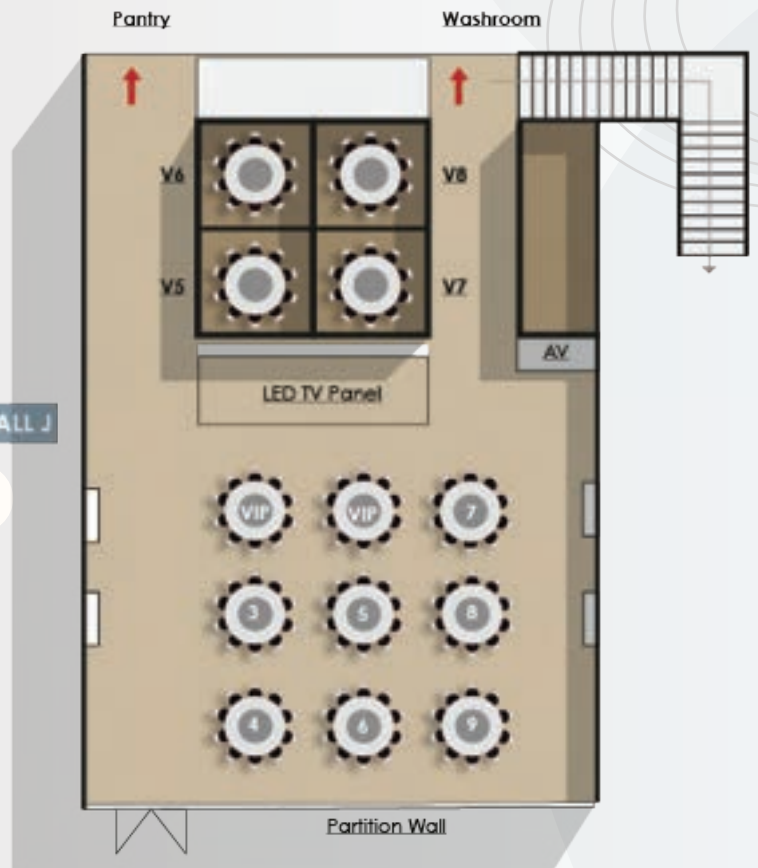

HALL C



HALL J



HALL C & J



# Parking



TIME	RATES	MEMBERS	GUESTS
11:30am - 04:59pm	\$2.00 first hour \$1.50/block of 30mins thereafter	B1 lots	B2 / B3 white lots 130 lots available*
05:00pm - 11:00pm	\$3.50/entry	B1 lots	B2 / B3 white Lots 130 lots available*

\*Subject to first comes, first served basis

# AV System



## INCLUSIVE OF:

- HDMI Cable
- Audio Cable
- 02 x Wireless Microphones (Battery Operated)
- AV System (16 channels) with In-House Lighting
- LED Screen in Hall A, B & C (Level 2)  
Resolution size: 1920 x 1080  
Video / Photo Montage: 16:9 format
- Projector in Training Rooms (Level 3 & 4)
- AV sound system in Training Rooms (Level 3 & 4)





醉花林品潮軒  
CHUI HUAY LIM TEOCHEW CUISINE

Chui Huay Lim Teochew Cuisine  
190 Keng Lee Road, #01-02  
Singapore 308409

 +65 89625 0489  [events@jumbogroup.com.sg](mailto:events@jumbogroup.com.sg)

 [zuiteochewcuisine](https://www.facebook.com/zuiteochewcuisine) 